

AWE ALUMINIUM PRODUCTS



Discover Our Range



01792582678



Sales@awealuminium.co.uk





BI-FOLD SYSTEM

BI-FOLD

SYSTEM

Sightline Frame 73 mm, Sash 73 mm

Polyamide strip length

Frame 20 mm

Sash 30 mm

Profile thickness

Door 1.8 mm

Glazing

Max. 45 mm, Min. 25 mm

Maximum sash dimensions

Width (L) 1,200 mm, Height (H) 3,000 mm

Maximum sash weight

120 kg

Consult maximum weight and dimensions according to typologies

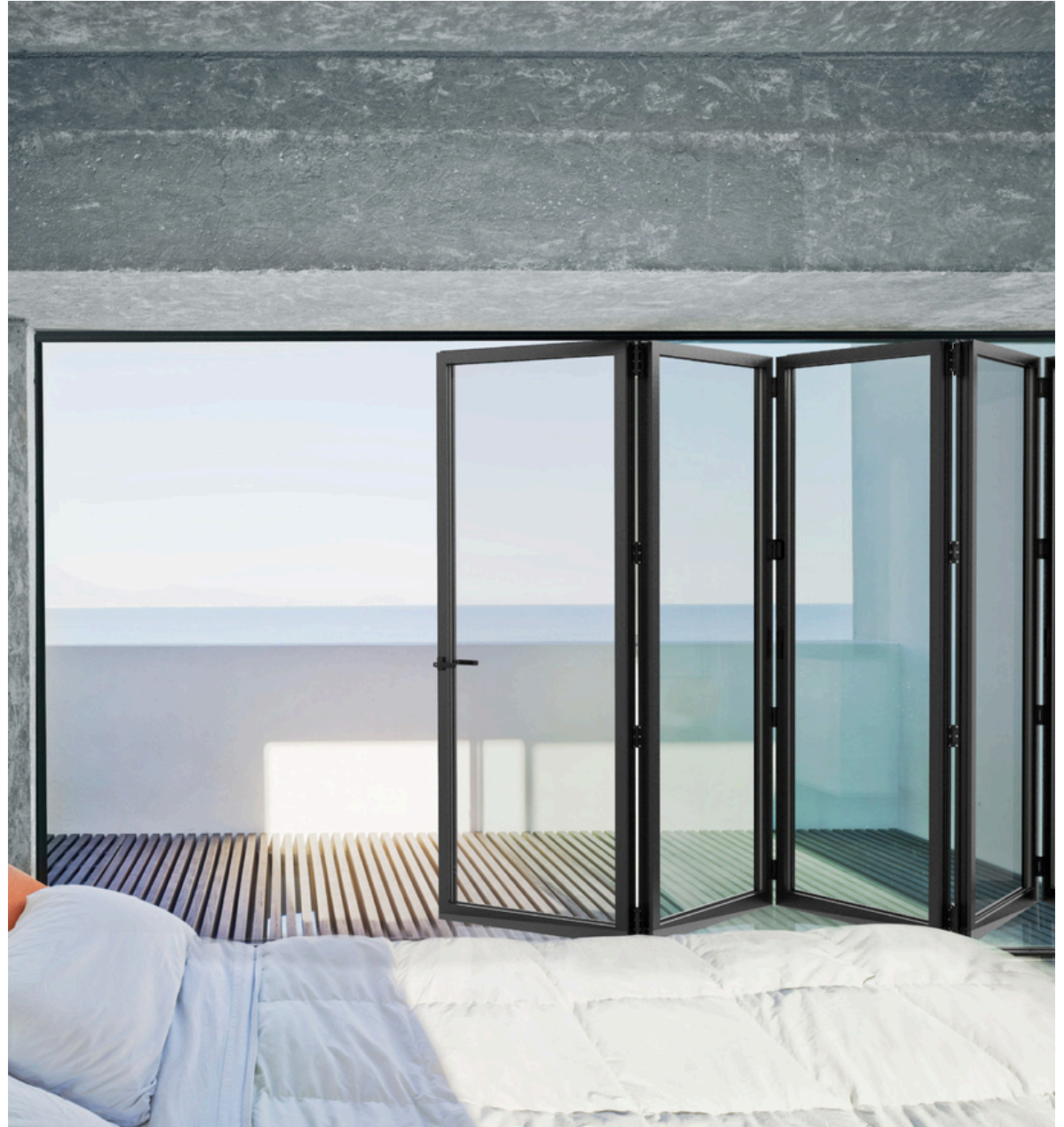



Bi-fold door system with 73 mm of frame depth and optimal thermal and acoustic performances, ideal for moderate climates.



- Maximum sizes 1,200 x 3,000 mm
- Open corner solution
- Up to 14 sashes
- Adjustable jamb available
- High security

BFRC Rating
kWh/(m²·yr)

≥20	A ++
>10 to 20	A +
0 to <10	A
-10 to <0	B
-20 to <-10	C ✓
-30 to <-20	D
-50 to <-30	E

Double glazing

BFRC Rating
kWh/(m²·yr)

≥20	A ++
>10 to 20	A +
0 to <10	A
-10 to <0	B ✓
-20 to <-10	C
-30 to <-20	D
-50 to <-30	E



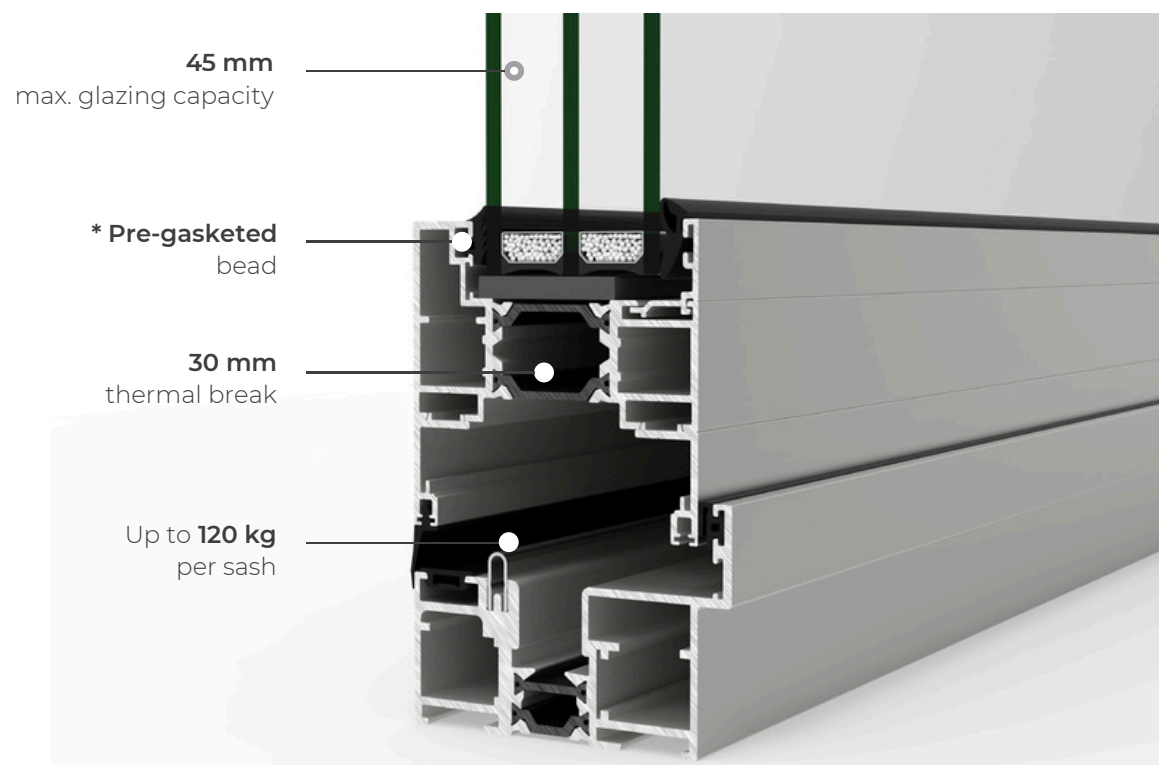

Triple glazing



* Available for 24 and 28 mm glazing only



FEATURES

U-value		Double glazing * $U \geq 1.4 (W/m^2K)$	Triple glazing * $U \geq 1.0 (W/m^2K)$
Air permeability			Class 4
Watertightness			Class 9A
Wind resistance			Class A3
Security test			Passed

* Double glazing $U_g = 1.0$ / Triple glazing $U_g = 0.5$ Wind resistance: reference test 2.700 x 2.530 m / 3 sashes
Security test: Configuration 330. 2701 x 2517 mm / 3 sashes

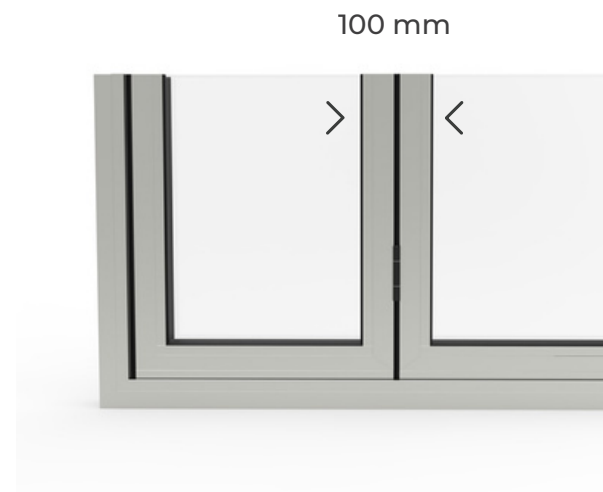

DRAINAGE SUBCILLS

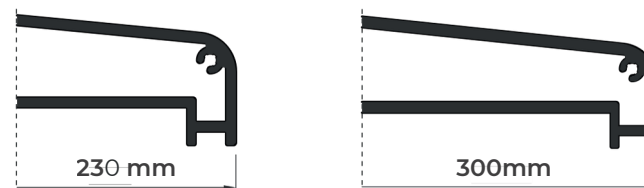
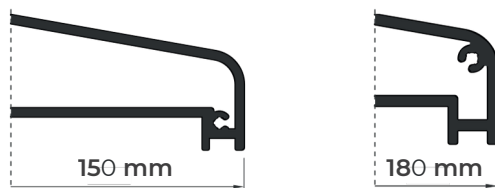
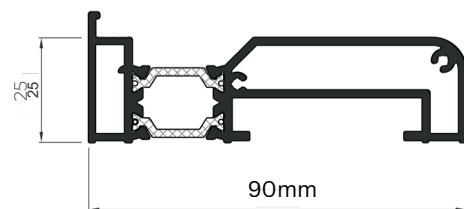

FRAME

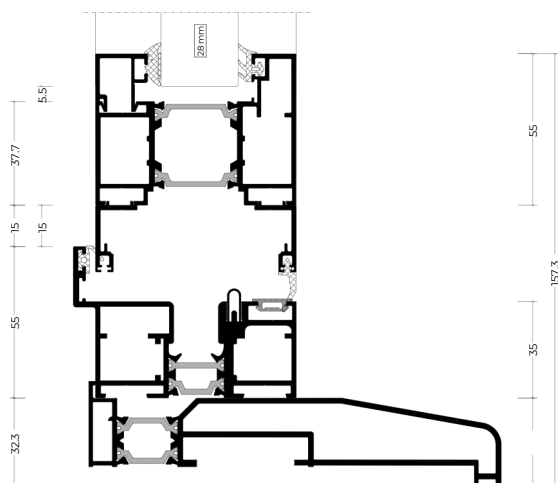

THRESHOLD

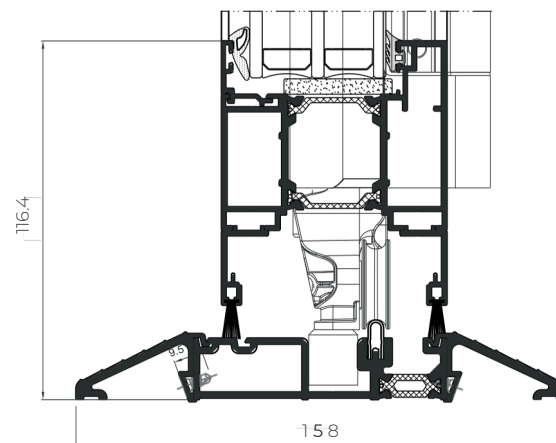

SLIM SIGHTLINES

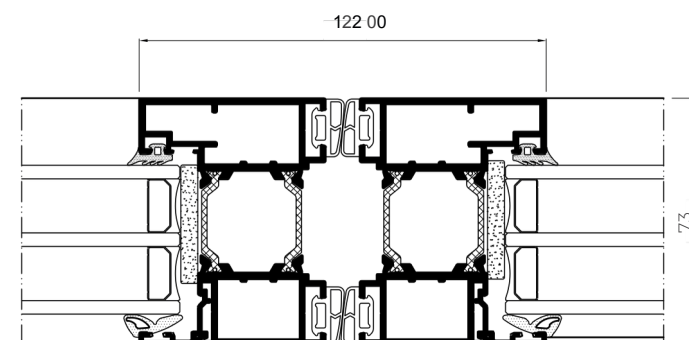

HEAD EXTENSION

Head extension 20 mm

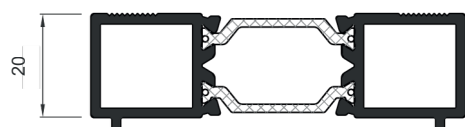

Head extension 38 mm

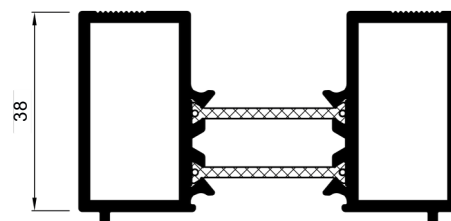

OPENING POSSIBILITIES



Inward
Up to 14 sashes

Outward
Up to 14 sashes
90° corner sash without mullion

POSSIBILITIES



SECURITY
HARDWARE



ACCESSIBILITY



BI-FOLD PLUS SYSTEM

BI-FOLD PLUS

SYSTEM

Sightline Jamb 89 mm, Meeting Stile 110 mm

Polyamide strip length

Frame 45 mm

Sash 45 mm

Profile thickness

Door 1.8 mm

Glazing

Max. 48 mm, Min. 25 mm

Maximum sash dimensions

Width (L) 1,200 mm, Height (H) 3,000 mm

Maximum sash weight

120 kg

Consult maximum weight and dimensions according to typologies





Separate environments and unify spaces with this Bi-fold door system with an 80 mm deep frame. This evolution of the Bi-fold series offers an excellent thermal and acoustic performance, thanks to its 45 mm thermal break and a glazing capacity up to 48 mm. Besides, it presents a slim central section of 110 mm, which maximizes the glazed surface, filling the interior spaces with natural light.



- High thermal & acoustic performance
- Maximized glazed surface
- Double bearing system with a gimbal stabiliser
- Faster manufacturing
- High security

BFRC Rating
kWh/(m².yr)

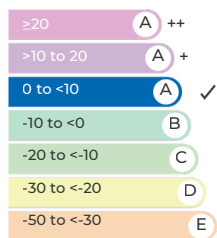

Double glazing



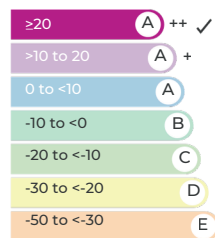

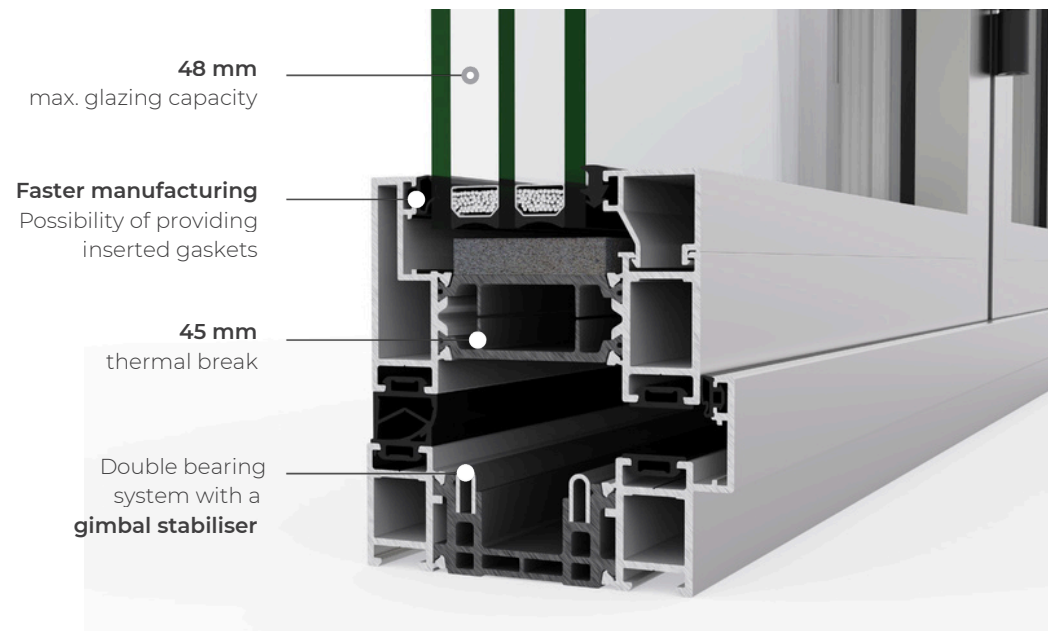

BFRC Rating
kWh/(m².yr)



Triple glazing





FEATURES			
U-value		Double glazing* U _g ≥ 1.2 (W/m²K)	Triple glazing* U _g ≥ 0.78 (W/m²K)
Air permeability		Class 4	
Watertightness		Class E750	
Wind resistance		Class C3	
Repeated openings and closings		50,000 cycles (Main swing door)	25,000 cycles (Even sashes)
Security test		Passed	

* Double glazing Ug=1.0 / Triple glazing Ug=0.5



Security test: 3 sashes reference test. Configuration 321 2.70 x 2.50 m
 AWW TEST. Resistance to repeated openings and closings: EN 1191, 3 sashes reference test.
 Configuration 321 3.73 x 2.50 m

DRAINAGE SUBCILLS

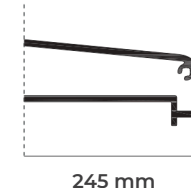
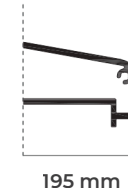
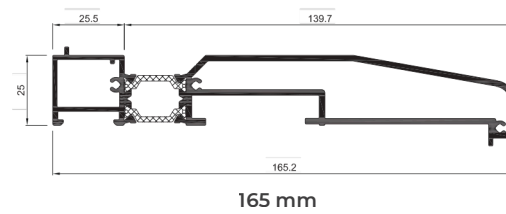
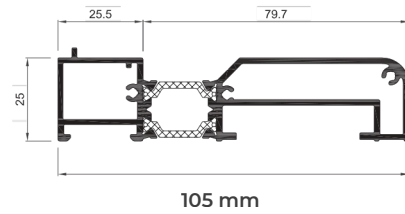

PROFILES WITH INSERTED GASKET

Sash

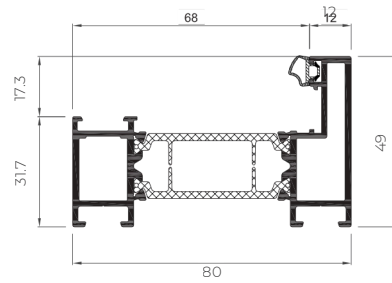

Outer Frame

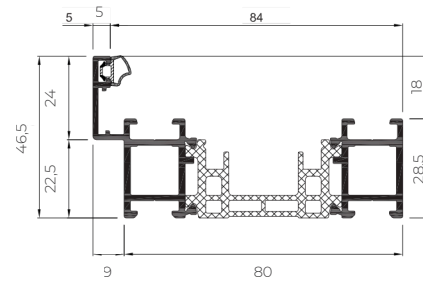

Glazing beads

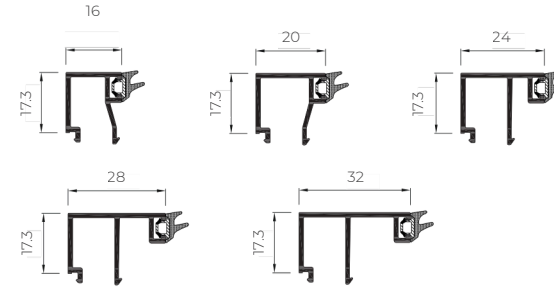

HEAD EXTENSION

Head extension 25 mm

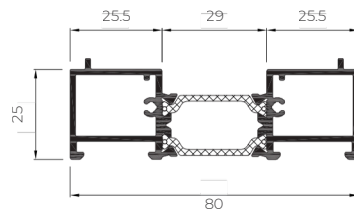

Head extension 37 mm

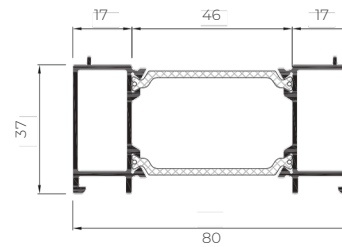

OPENING POSSIBILITIES



Inward
Up to 14 sashes

Outward
Up to 14 sashes
90° corner sash without mullion

POSSIBILITIES





CASEMENT SYSTEM

CASEMENT

SYSTEM

Sightlines

Frame 70 mm, Sash 70 mm

Polyamide strip length

32 mm

Profile thickness

Window 1.6 mm

Glazing

Max. 44 mm, Min. 23 mm

Maximum sash dimensions

Slim sash (Side hung):

Width (L) 950 mm, Height (H) 1,300 mm

Slim sash (Top hung):

Width (L) 1,200 mm, Height (H) 1,300 mm

Heavy Duty sash (Side hung):

Width (L) 750 mm, Height (H) 1,750 mm

Heavy Duty sash (Top hung):

Width (L) 1,800 mm, Height (H) 1,800 mm

Maximum sash weight

Side Hung Slim Sash: 35 kg

Top Hung Slim Sash: 50 kg

Side Hung Heavy Duty Sash: 42 kg

Top Hung Heavy Duty Sash: 100 kg

Consult maximum weight and dimensions according to typologies





Thermally broken window that allows for both side hung and top hung outward openings. This solution, with a thermal break zone of 32 mm and a transmittance U_w from $1.0 \text{ W/m}^2\text{K}$, has the British security certification PAS 24, being especially suitable for this market.



- High thermal & acoustic performance
- Slim sightlines
- Flush option available
- High security

BFRC Rating
kWh/(m².yr)

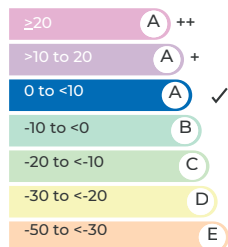

Double glazing

BFRC Rating
kWh/(m².yr)

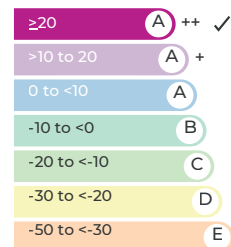

Triple glazing

44 mm
max. glazing capacity

* Pre-gasketed
bead

32 mm
thermal break



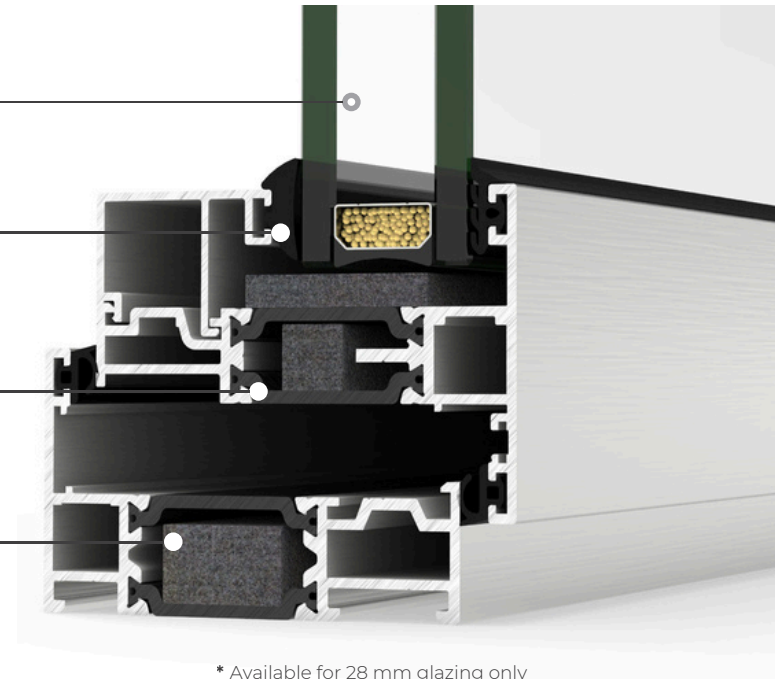

High
insulation foam



* Available for 28 mm glazing only

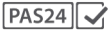

FEATURES

U-value		Double glazing * Uw ≥ 1.4 (W/m²K)	Triple glazing * Uw ≥ 1.0 (W/m²K)
Acoustic insulation		Rw up to 45 dB	
Air permeability		Class 4	
Watertightness		Class E1200	
Wind resistance		Class CE 2400	
Security test		Passed	

* Double glazing Ug=1.0 / Triple glazing Ug=0.5

Security test: Reference test 1.438 x 1.33 m / 1 sash



Flush version



Standard version

FLUSH VERSION

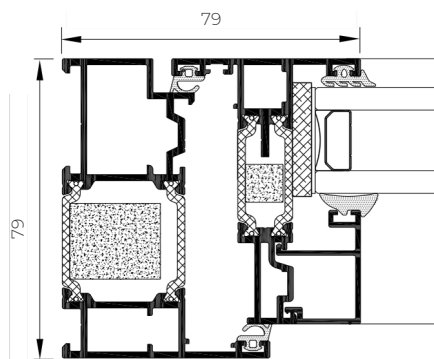

STANDARD VERSION

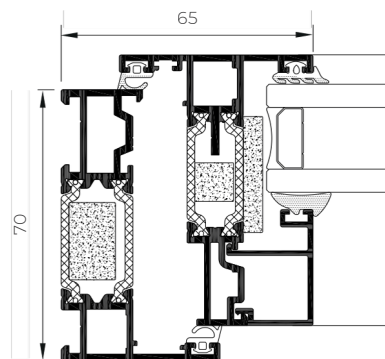

HIGH FRAME

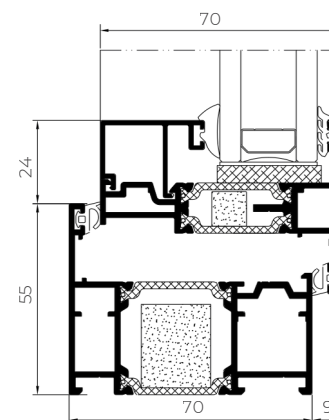

DRAINAGE SUBCILLS

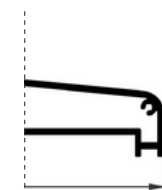
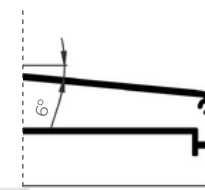
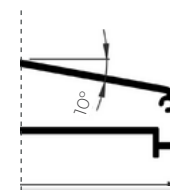
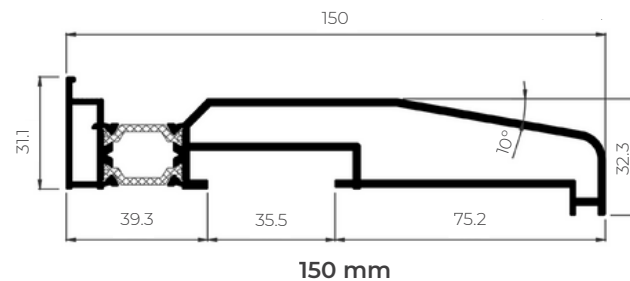
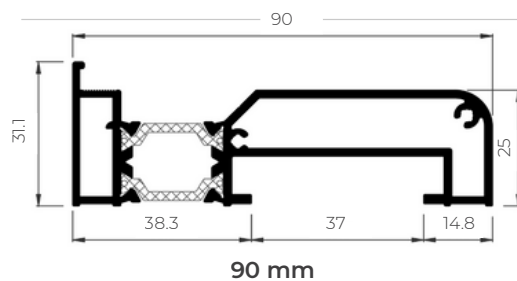

HEAD EXTENSION

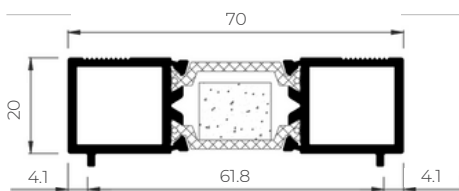

Head extension 20 mm

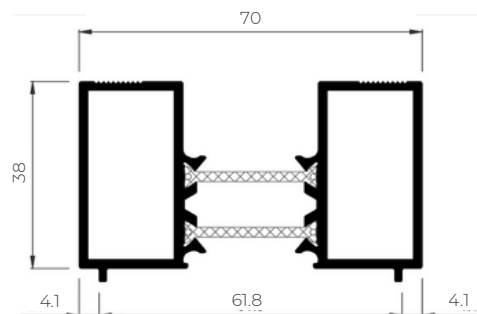

Head extension 38 mm

OPENING POSSIBILITIES



Outward Opening
Side hung
Top hung

POSSIBILITIES



SECURITY
HARDWARE



CONCEALED
HINGES



COR 70 HIDDEN SASH SYSTEM

COR 70 HIDDEN SASH

SYSTEM

Sightlines

Frame 70 mm, Sash 70 mm

Polyamide Strip Length

35 mm

Profile Thickness

Window 1.9 mm

Glazing

Max. 40 mm, Min. 26 mm

Maximum Sash Dimensions

Standard Solution:

Width (L) 1300 mm, Height (H) 2400 mm

HD Hardware (Side Hung):

Width (L) 1200 mm, Height (H) 3500 mm

Maximum Sash Weight

160 Kg

Consult maximum weight and dimensions according to typologies





It could be a painting, but is a window. This is how we can describe the COR 70 Hidden Sash which, like the 80 mm version, has a sightline of only 66 mm and allows the incorporation of the ARCH INVISIBLE handle, concealed hinges and the drainage solution. Any element that breaks the visual harmony of the ensemble is discarded.



- High thermal & acoustic performance
- Slim sightlines
- Hidden handle and concealed hinges available
- High security

BFRC Rating
kWh/(m².yr)

≥20	A ++
>10 to 20	A +
0 to <10	A ✓
-10 to <0	B
-20 to <-10	C
-30 to <-20	D
-50 to <-30	E

Double glazing

BFRC Rating
kWh/(m².yr)

≥20	A ++
>10 to 20	A + ✓
0 to <10	A
-10 to <0	B
-20 to <-10	C
-30 to <-20	D
-50 to <-30	E

Triple glazing

40 mm
glazing capacity

Hidden Sash
Profile

High
Insulation foam

* Half Hidden Sash possibility

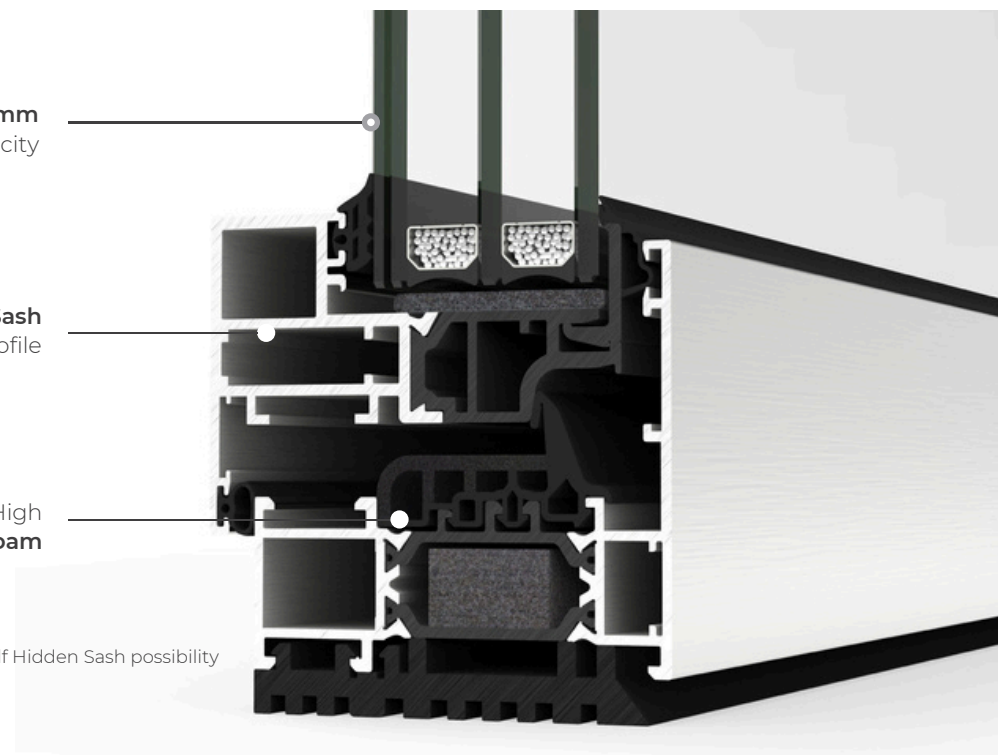



FEATURES

U value		Double glazing * Uw from 1.1 (W/m²K)	Triple glazing * Uw ≥ 0.81 (W/m²K)
Acoustic insulation		Rw up to 46 dB	
Air permeability		Class 4	
Water tightness		Class E1650	
Wind resistance		Class C5	
Security test		Passed	

* Double glazing Ug=1.0 / Triple glazing Ug=0.6
 Reference test 1.23 x 1.48 m / 1 sash
 Security test: Reference test 1.100 x 2.400 m / 1 sash
 CSTB Laboratory DTA Certification

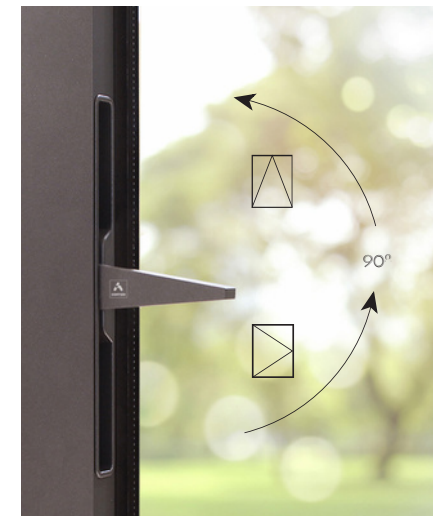

ARCH INVISIBLE HANDLE

CROSS SECTION

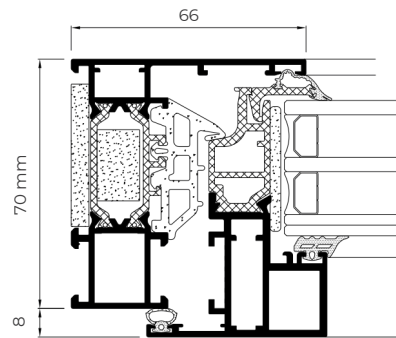

HALF HIDDEN SASH

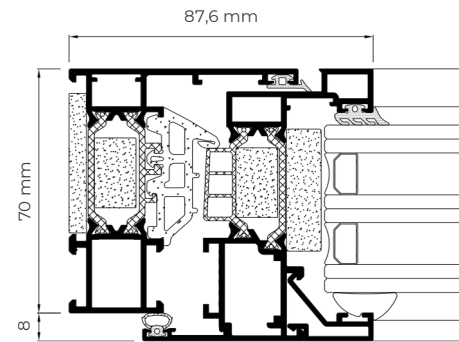

FLOATING MULLION

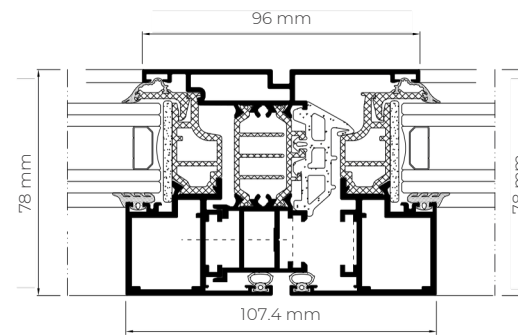

HIDDEN DRAINAGE

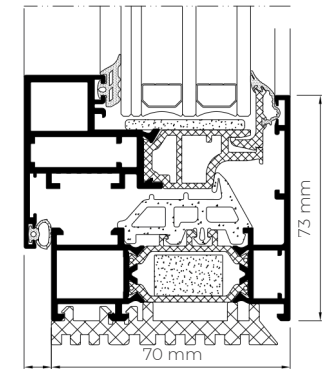

DRAINAGE SUBCILLS

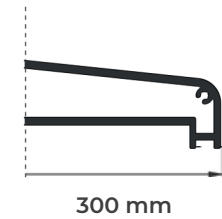
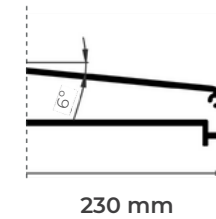
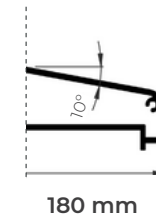
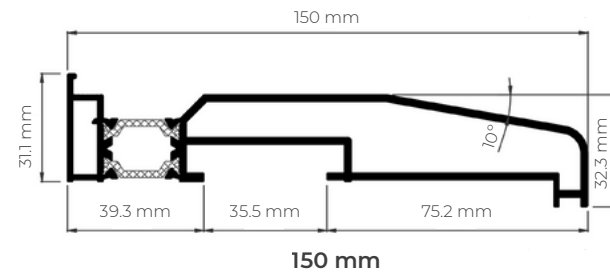
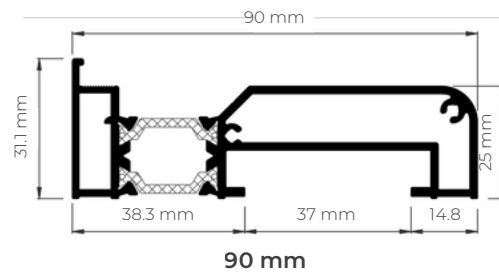

HEAD EXTENSION

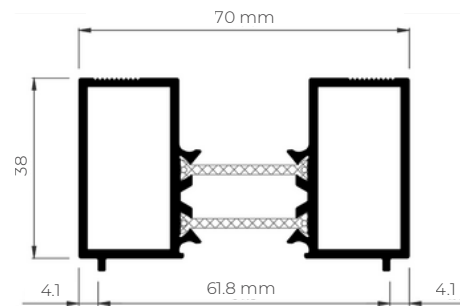
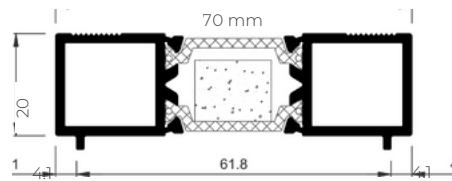

POSSIBILITIES



SECURITY
HARDWARE



CONCEALED
HINGES



CONCEALED
HANDLE



CONCEALED
DRAINAGE

OPENING POSSIBILITIES



Inward Opening
Side hung
Tilt & turn
Tilt only
Parallel sliding

Head Extension 20 mm

Head Extension 38 mm



4700 IN-LINE SLIDER / LIFT & SLIDE SYSTEM

4700 IN-LINE SLIDER / LIFT & SLIDE

SYSTEM

Sightlines

Frame depths 115 and 120 mm, 185 mm 3 rails

Interlock 47 mm

Polyamide strip length

20-25 mm

Profile thickness

Balcony door 1.5 mm

Glazing

Max. 36 mm, Min. 26 mm

Maximum sash dimensions

Width (L) 2,500 mm, Height (H) 3,000 mm

Maximum sash weight

Slide 280 kg

Lift & slide 300 kg

Consult maximum weight and dimensions according to typologies





This sliding system, available both in-line slider and lift & slide versions, becomes an ideal solution for closing large spans. It presents modern aesthetics in straight lines, a reduced interlock section and large glazed surfaces that ensure bright and comfortable areas, due to its thermal and acoustic performance.



- Up to 3 metres high
- Maximized glazed surface
- 47 mm interlock
- Faster manufacturing
- High security

BFRC Rating
kWh/(m².yr)

≥20	A	++
>10 to <20	A	+
0 to <10	A	
-10 to <0	B	
-20 to <-10	C	✓
-30 to <-20	D	
-50 to <-30	E	

Double glazing

BFRC Rating
kWh/(m².yr)

≥20	A	++
>10 to <20	A	+
0 to <10	A	
-10 to <0	B	✓
-20 to <-10	C	
-30 to <-20	D	
-50 to <-30	E	

Triple glazing

36 mm
max. glazing capacity

*** Pre-gasketed**
bead

Adjustable
wheels



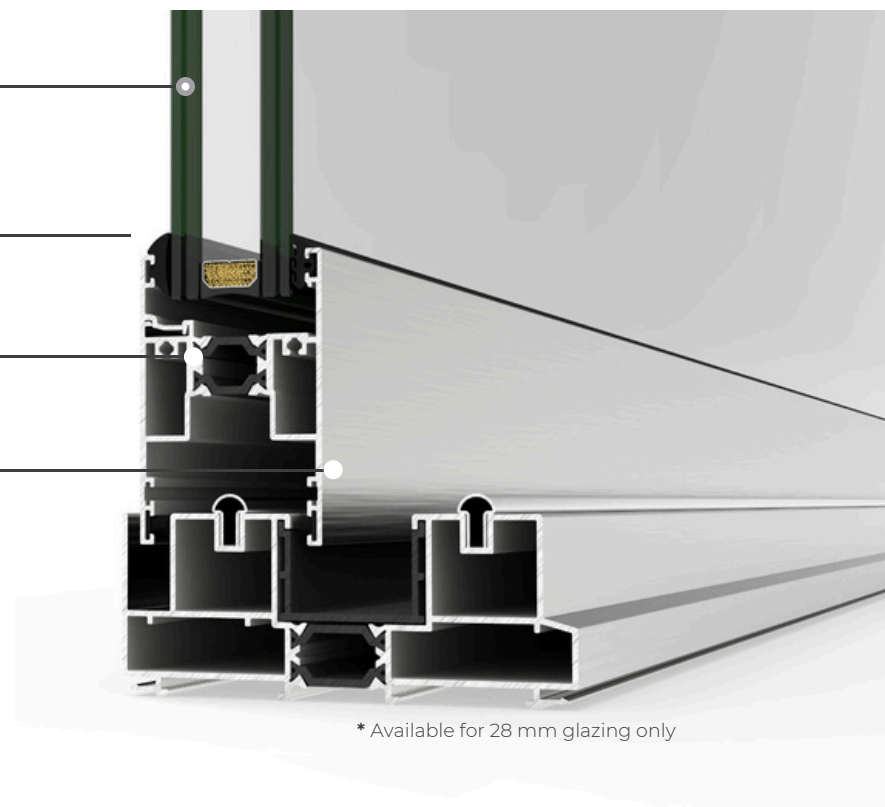



In-line / lift & slide
versions



* Available for 28 mm glazing only



FEATURES

U-value (I)		Double glazing Uw ≥ 1.4 (W/m²K)	Triple glazing Uw ≥ 1.2 (W/m²K)
Acoustic insulation		Rw up to 40 dB	
Air permeability		Class 3* / 4**	
Watertightness		Class 7A	
Wind resistance		Class C5* / C2**	
Security test		Passed	

Double glazing Ug=1.0 / Triple glazing Ug=0.7

(I) Two sashes 5 m x 3 m



In-line slider



Lift & slide

* Reference slide test 1.8 x 2.2 m / 2 sashes / ** Reference lift & slide test 4.0 x 2.50 m / 2 sashes
Security test: Reference test 2.40 x 2.40 m / 2 sashes

IN-LINE SLIDER

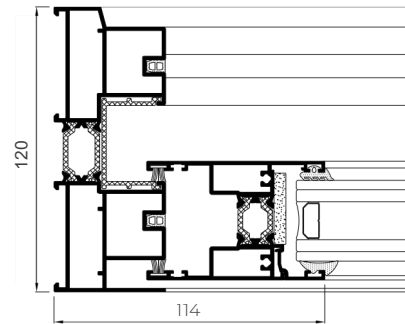

LIFT & SLIDE

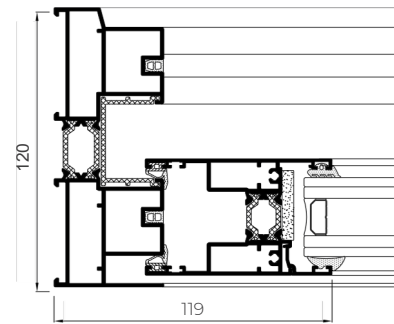

47 mm INTERLOCK

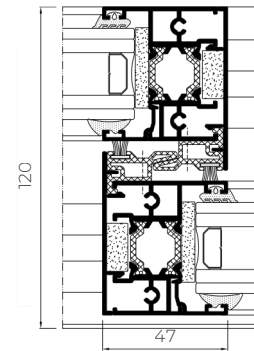

100 mm INTERLOCK

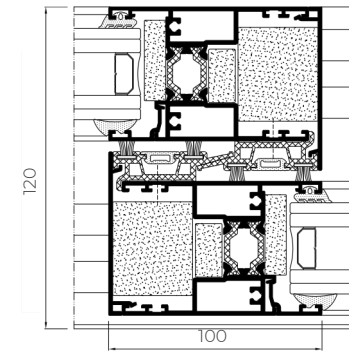

DRAINAGE SOLUTIONS

Hidden drainage

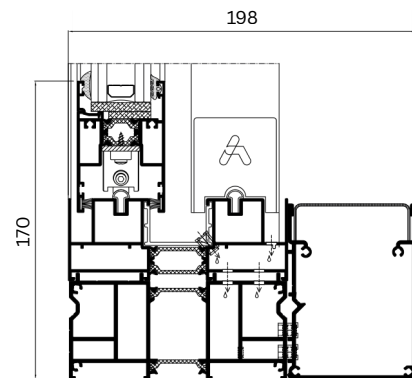

250 mm subcill

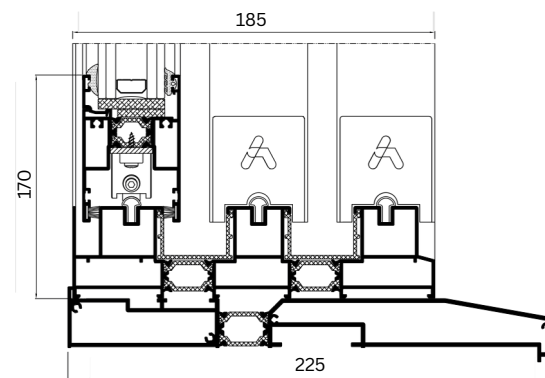

HEAD EXTENSION - 38 mm

Double track

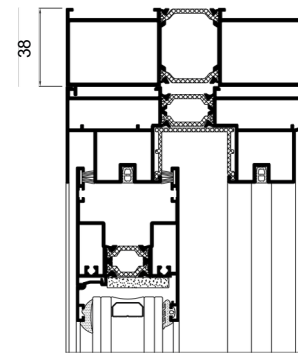

Triple track

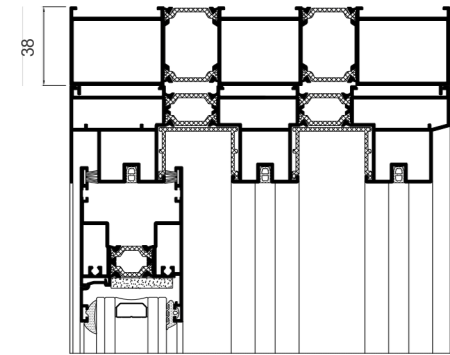

OPENING POSSIBILITIES

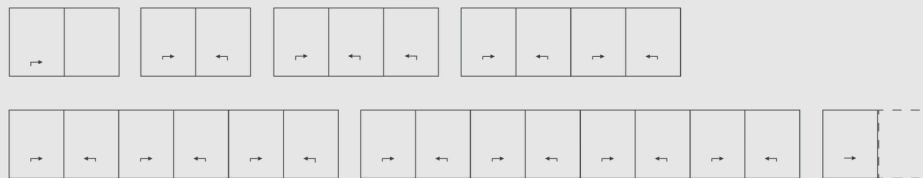

Sliding
1 rail (1 sash + 1 fixed light)
2, 3 & 4 rails
In-pocket

POSSIBILITIES



ACCESSIBILITY



COR VISION SYSTEM

COR VISION

SYSTEM

Sightlines

Frame depth 116 mm / 182 mm 3 rails

Sash depth 37 mm

Interlock 20 mm

Polyamide Strip Length

16 / 24 mm

Profile Thickness

Door 1.7 mm

Glazing

Max. 30 mm, Min. 26 mm

Maximum Sash Dimensions

Width (L) 2500 mm, Height (H) 3000 mm

Maximum Sash Weight

320 kg

Consult maximum weight and dimensions according to typologies





Thermally broken minimalist sliding system that provides maximum luminosity with a minimal aluminium interlock profile. It has an elegant design only 20 mm sightline and offers the possibility of an inlaid closing system and of hiding the frame along the perimeter.

Possibility of locking system in the interlock, thus allowing the concealment of the sashes in the frame from a frontal view. Possibility of embedded locking system which facilitates the sashes crossing.



- High thermal & acoustic performance
- Maximized glazed surface
- Stainless steel adjustable wheels
- 20 mm interlock
- Hidden track possibility





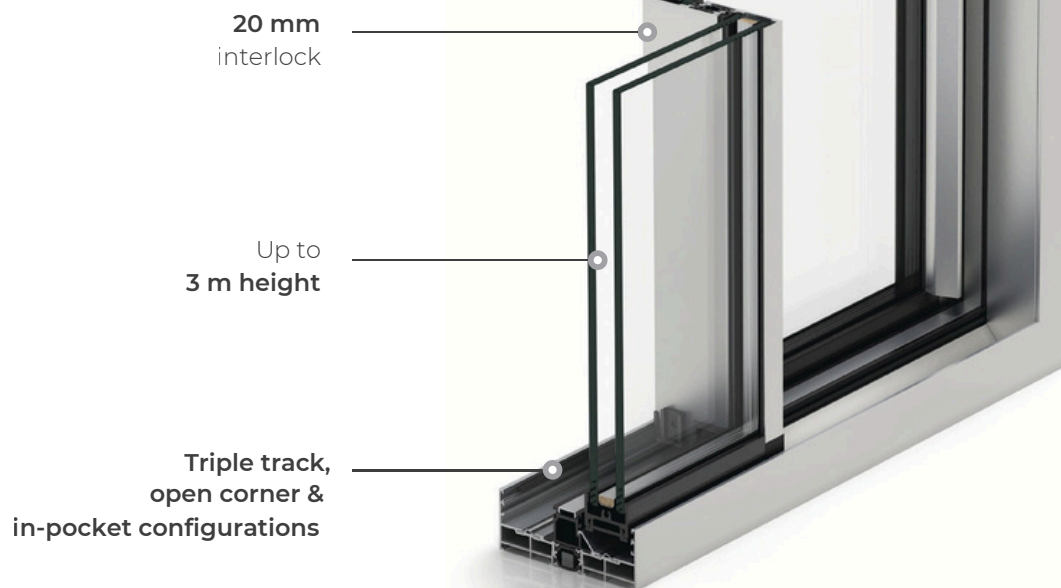

BFRC Rating
kWh/(m².yr)

≥20	A	++
>10 to 20	A	+
0 to <10	A	✓
-10 to <0	B	
-20 to <-10	C	
-30 to <-20	D	
-50 to <-30	E	

Double glazing





FEATURES		
U value		$U_w \geq 1.3 \text{ (W/m}^2\text{K)}$
Acoustic insulation		Rw up to 41 dB
Air permeability		Class 4
Water tightness		Class 7A
Wind resistance		Class C5
Security test		Passed

Reference test 1.23 x 1.55 m / 1 sash + 1 fixed light



INTERLOCK HANDLE



SECURITY
HARDWARE

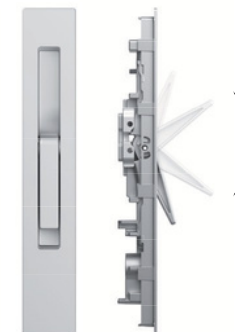

FLUSH SECURITY
HARDWARE

HIDDEN TRACK SOLUTION

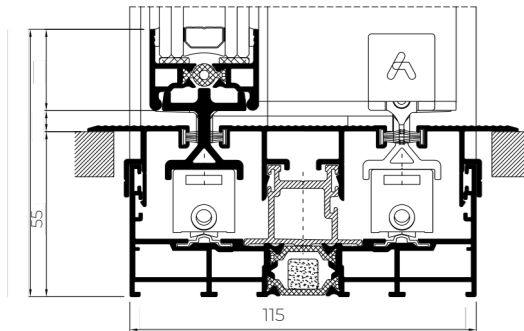

BESPOKE DRAINAGE SOLUTION

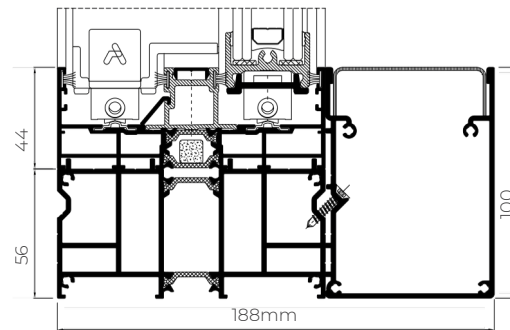

INTERLOCK HANDLE

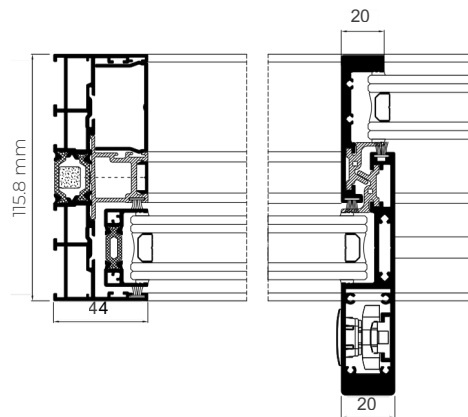

DOUBLE TRACK

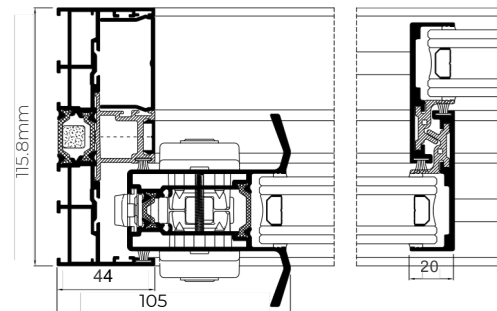

HIDDEN TRACK SOLUTION

OPENING POSSIBILITIES

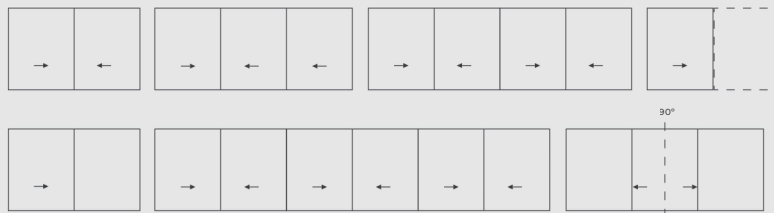

Sliding

Possibility of 1, 2 or 3 rails

Possibility of interior and exterior corner sash at 90° without mullion

Pocket possibility

POSSIBILITIES



ACCESSIBILITY

A modern kitchen interior featuring a large window with a black frame, offering a view of a lush garden with palm trees and a white house. To the right, there are white kitchen cabinets with a white countertop and a black faucet. Above the countertop, there are black shelves holding various jars and containers. A white pendant light hangs from the ceiling on the left. The overall aesthetic is clean and contemporary.

About us

.....

Located in South Wales with national deliveries, AWE Aluminium is dedicated to helping you find the best supplies for you. Since 2018, we've been striving to create lasting relationships with our customers, and guarantee that they can count on us for the best quality materials and service possible.



ALUMINIUM

sales@awealuminium.co.uk

01792 582678

07860651655